

Siłowniki od YS 5,0/25 do YS 30,0/200

Wymiary

Wymiary	A	B	C	D	E	F	H	J	K	O	P	U	V	W	X	Z
Typ	mm	mm	mm	mm	mm	mm	mm	mm	mm	mm	mm	mm	mm	mm	mm	°
YS-5/25	97,0	122,0	92,0	42,0	30,0	26,0	19,0	25,0	5,0	M20 x 2	13,0	28,0	2 x M6	23,0	M42 x 1.5	5,0
YS-5/75	157,0	232,0	152,0	42,0	30,0	26,0	19,0	25,0	5,0	M20 x 2	13,0	28,0	2 x M6	23,0	M42 x 1.5	5,0
YS-5/127	214,0	341,0	209,0	42,0	30,0	26,0	19,0	25,0	5,0	M20 x 2	13,0	28,0	2 x M6	23,0	M42 x 1.5	5,0
YS-5/180	267,0	447,0	262,0	42,0	30,0	26,0	19,0	25,0	5,0	M20 x 2	13,0	28,0	2 x M6	23,0	M42 x 1.5	5,0
YS-10/25	90,0	115,0	88,0	57,0	43,0	38,0	17,0	-	3,0	-	-	35,0	2 x M8	27,0	M57 x 1.5	5,0
YS-10/50	125,0	175,0	119,0	57,0	43,0	38,0	19,0	35,0	6,0	M27 x 2	17,0	35,0	2 x M8	27,0	M57 x 1.5	5,0
YS-10/100	178,0	278,0	172,0	57,0	43,0	38,0	19,0	35,0	6,0	M27 x 2	17,0	35,0	2 x M8	27,0	M57 x 1.5	5,0
YS-10/150	250,0	400,0	244,0	57,0	43,0	38,0	21,0	35,0	6,0	M27 x 2	22,0	35,0	2 x M8	27,0	M57 x 1.5	-
YS-10/200	300,0	500,0	294,0	57,0	43,0	38,0	21,0	35,0	6,0	M27 x 2	22,0	35,0	2 x M8	27,0	M57 x 1.5	-
YS-10/250	352,0	602,0	346,0	57,0	43,0	38,0	21,0	35,0	6,0	M27 x 2	22,0	35,0	2 x M8	27,0	M57 x 1.5	-
YS-10/300	407,0	707,0	401,0	57,0	43,0	38,0	21,0	35,0	6,0	M27 x 2	22,0	35,0	2 x M8	27,0	M57 x 1.5	-
YS-15/25	110,0	135,0	103,0	67,0	52,0	46,0	19,0	40,0	7,0	M33 x 2	19,0	42,0	2 x M10	33,0	M67 x 1.5	5,0
YS-15/50	140,0	190,0	133,0	67,0	52,0	46,0	19,0	40,0	7,0	M33 x 2	19,0	42,0	2 x M10	33,0	M67 x 1.5	5,0
YS-15/100	190,0	290,0	183,0	67,0	52,0	46,0	19,0	40,0	7,0	M33 x 2	19,0	42,0	2 x M10	33,0	M67 x 1.5	5,0
YS-15/150	260,0	410,0	253,0	67,0	52,0	46,0	22,0	40,0	7,0	M33 x 2	25,0	42,0	2 x M10	33,0	M67 x 1.5	-
YS-15/200	310,0	510,0	303,0	67,0	52,0	46,0	22,0	40,0	7,0	M33 x 2	25,0	42,0	2 x M10	33,0	M67 x 1.5	-
YS-15/250	365,0	615,0	358,0	67,0	52,0	46,0	22,0	40,0	7,0	M33 x 2	25,0	42,0	2 x M10	33,0	M67 x 1.5	-
YS-15/300	420,0	720,0	413,0	67,0	52,0	46,0	22,0	40,0	7,0	M33 x 2	25,0	42,0	2 x M10	33,0	M67 x 1.5	-
YS-15/350	472,0	822,0	465,0	67,0	52,0	46,0	22,0	40,0	7,0	M33 x 2	25,0	42,0	2 x M10	33,0	M67 x 1.5	-
YS-23/25	116,0	141,0	113,0	85,0	65,0	56,0	20,0	50,0	3,0	M40 x 2	15,0	55,0	2 x M10	40,0	M85 x 2	5,0
YS-23/50	150,0	200,0	142,0	85,0	65,0	56,0	22,0	50,0	8,0	M40 x 2	22,0	55,0	2 x M10	40,0	M85 x 2	-
YS-23/100	202,0	302,0	194,0	85,0	65,0	56,0	22,0	50,0	8,0	M40 x 2	22,0	55,0	2 x M10	40,0	M85 x 2	-
YS-23/160	277,0	437,0	269,0	85,0	65,0	56,0	22,0	50,0	8,0	M40 x 2	25,0	55,0	2 x M10	40,0	M85 x 2	-
YS-23/210	330,0	540,0	322,0	85,0	65,0	56,0	22,0	50,0	8,0	M40 x 2	25,0	55,0	2 x M10	40,0	M85 x 2	-
YS-23/250	376,0	626,0	368,0	85,0	65,0	56,0	22,0	50,0	8,0	M40 x 2	25,0	55,0	2 x M10	40,0	M85 x 2	-
YS-23/300	428,0	728,0	420,0	85,0	65,0	56,0	22,0	50,0	8,0	M40 x 2	25,0	55,0	2 x M10	40,0	M85 x 2	-
YS-23/345	477,0	822,0	469,0	85,0	65,0	56,0	22,0	50,0	8,0	M40 x 2	25,0	55,0	2 x M10	40,0	M85 x 2	-
YS-30/125	245,0	370,0	235,0	102,0	75,0	65,0	25,0	50,0	10,0	M36 x 2	25,0	75,0	2 x M10	45,0	M102 x 2	-
YS-30/200	325,0	525,0	315,0	102,0	75,0	65,0	25,0	50,0	10,0	M36 x 2	25,0	75,0	2 x M10	45,0	M102 x 2	-

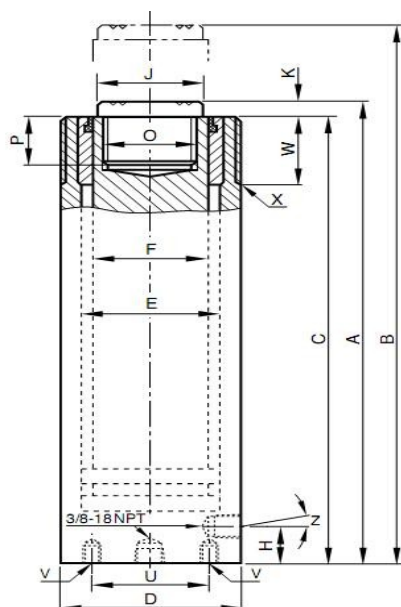

TRANSREM - Opole

45-701 Opole, ul. Wrocławska 62
tel.: 077 451 73 64, fax: 077 451 40 90
e-mail: opole@transrem.com.pl

TRANSREM - Filia Wrocław

55-080 Kąty Wrocławskie, ul. Główna 62, Sośnica
tel.: 071 789 13 08, fax: 071 789 13 11
e-mail: wroclaw@transrem.com.pl

TRANSREM - Filia Katowice

40-083 Katowice, ul. Gliwicka 234
tel.: 032 254 37 16, fax: 032 254 36 89
e-mail: katowice@transrem.com.pl